

INTERMOUNTAIN HEALTH CARE

Regional Food Service Master Plan of new Intermountain Medical Center
Salt Lake City, Utah

Objectives/Key Issues

To prepare for the development of a new medical center, Urban Central Region of Intermountain Health Care conducted a comprehensive master and functional planning process for the entire region. Key objectives of this study included:

- Determining the potential benefits of integrating the food service operations for the three existing hospitals;
- Developing a Regional Vision Statement for the Food Service Departments;
- An assessment of the current operations in all three hospitals, indicating opportunities to improve services
- An assessment of alternative delivery systems, including centralized cook-chill production and its implications for patient, retail and catering services.

Outcomes

The Master Plan presented five delivery alternatives from centralized to decentralized production. After thorough discussions and reviews IHC selected decentralized central production with on-site finishing kitchens. Space programs and cost estimates for retrofitting and building new central production kitchen were developed.

Envision Strategies Services Provided:

- 2001 Master Plan for Food & Nutrition Dept.
 - Assessment of Existing Condition
 - Development of Vision Statement
 - Development and Assessment of Alternative Solutions with Operating Targets
 - Preliminary Space Program and Capital Cost Estimates
 - Transitional Planning
- 2002 Detailed Space Programming
 - LDS Hospital
 - Cottonwood Hospital
 - Alta View Hospital
 - New Intermountain Medical Center w/Regional Commissary Kitchen

Hospital Characteristics

Total Future Beds – 700
Main Kitchen – 5,000 SF
Market Place – 4,300 SF
Projected Annual Patient Meals – 535,800
Projected Non-Patient Meals – 861,400

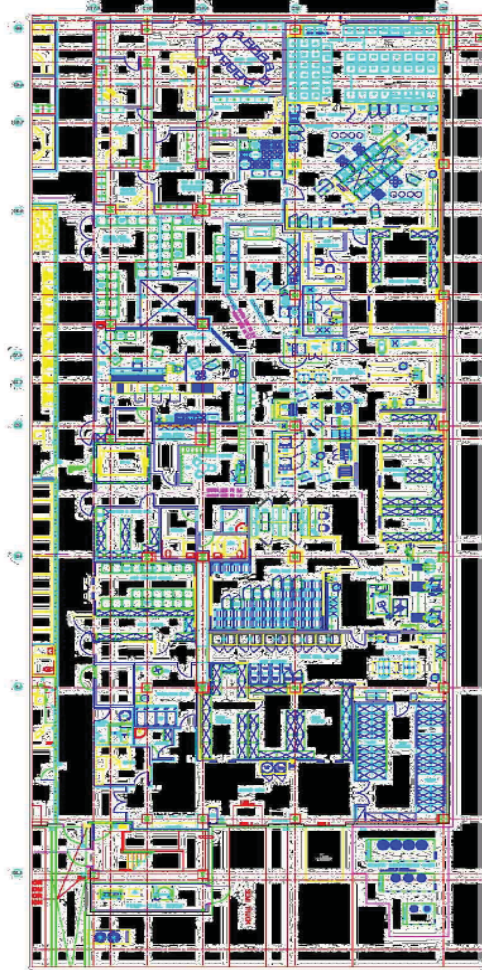

Client

Intermountain Health Care
LDS Hospital 8th and C Street
Salt Lake City, UT 84143
Contact: Ms. Pat Scott, Regional Director of Food Services
Phone: 801-408-1730
Email: CWPCOTT@ihc.com